

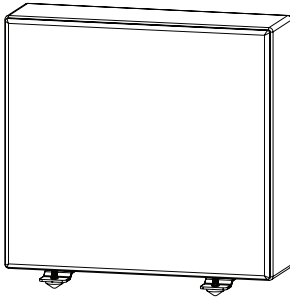

**TRIDENT**  
10" LOW PROFILE SUBWOOFER

*User Manual  
Trident Sub*



## Description

TruAudio is pleased to announce their new compact subwoofer, Trident. Artfully sleek and small enough to be “heard but not seen”, the Trident subwoofer uses a specially designed and highly efficient 10” aluminum cone woofer. The cabinet is braced internally to keep the output accurate and pure. You’ll be amazed at the volume and musicality of bass from this diminutive subwoofer. The ability to use the Trident forward, up-firing or even on-wall means you’ll never run out ways to utilize one. We maxed out our creativity so you could have full use of yours.

## Contents:

- (1) Compact 10” Sealed Subwoofer
- (1) Cloth Wrapped Magnetic Grill
- (2) Stabilizing Legs
- (4) Rubber Feet
- (4) Spike Feet
- (4) Magnetic Rubber Feet
- (1) TruAudio Badge
- (1) User Manual

## Amplification and Wiring

Because the Trident is a passive subwoofer it requires separate amplification. Our TRU-S500-DSP amplifier was developed in conjunction with the Trident for just that purpose. Instructions for using the Trident with the TRU-S500-DSP are included with the amplifier.

Because of the higher wattage necessary for this subwoofer compared to most architectural speakers we recommend using 14GA wire where possible and 12GA wire for runs longer than 40 feet. When connecting the speaker wire ensure that the polarity of the wiring is consistent with the rest of the system for best bass response.

## Subwoofer Placement

Choosing the right location place to put your subwoofer can sometimes be a difficult process. Fortunately the Trident sub allows for many different placement options, from out in the open to behind or underneath objects. Experiment with different locations to find the one that works best with your room and listening setup.

For even smoother bass response, it is possible to install more than one Trident sub in a room. When installing two Tridents the recommended placement configurations are:

- \* Locate one subwoofer in the front center of the room and the second in the rear center.
- \* Locate both subs on opposite side walls facing each other.
- \* Locate both subs along the same wall placing them at the 1/3 and 2/3 positions along the wall.

## Foot Options

Out of the box the Trident comes with stabilizing legs installed, along with adjustable rubber feet. This setup works great for most applications. On thick carpets or rugs where the subwoofer might be unstable it is best to swap the rubber feet for the carpet spikes included in the box. When using the sub in the up-firing position attach the magnetic rubber feet to the rear of the cabinet in approximately the same positions as the grill magnets on the cabinet face. This way the piano gloss finish will be protected and the sub will be less likely to vibrate against any hard surfaces.

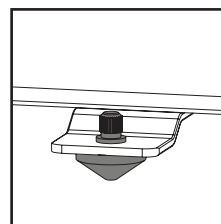

Adjustable Rubber Feet

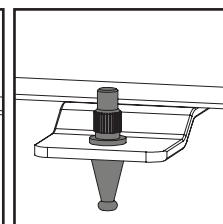

Spike Feet

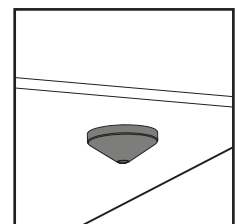

Magnetic Rubber Feet



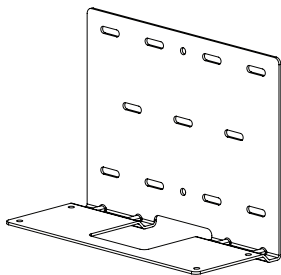

## Wall Mount Options

When installing the Trident using the optional T-10-SUB-WMB wall mount bracket, remove the stabilizing legs from the subwoofer cabinet completely. Keep the screws nearby as they will be reused.

Choose the position where you will mount your Trident subwoofer. It is not advisable to mount the Trident in any orientation other than front-firing on a vertical wall. The enclosure was not designed to handle the forces that result from other mounting orientations. For best results mount the bracket to a wall stud directly over where the speaker wire exits the wall.

Mount the bracket with the shelf toward the bottom, using screws or hardware appropriate for the surface it will be mounted to. The bracket must be **FIRMLY** secured to the wall. This subwoofer produces a LOT of bass and could come loose if the bracket is not mounted securely.

Using the screws that were removed with the stabilizing legs, mount the Trident to the T-10-SUB-WMB. Don't forget to connect the speaker wires to the subwoofer.

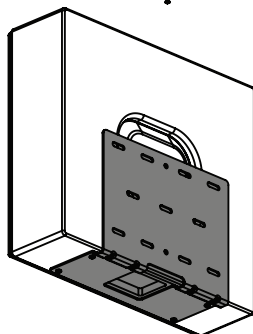
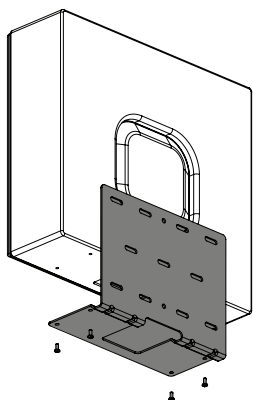

## TRIDENT Specifications

|                     |   |
|---------------------|---|
| Speaker Type:       | Subwoofer, Sealed   |
| Colors:             | White and Black   |
| Woofer:             | 10", Aluminum cone  |
| Cabinet:            | Sealed, MDF, Piano gloss finish                           |
| Grill Type:         | Cloth Wrapped, Magnetic                                   |
| Power:              | 250W RMS  |
| Sensitivity:        | 87 dB   |
| Freq Response:      | 25 to 250 Hz  |
| Impedance:          | 8 $\Omega$  |
| Overall Dimensions: | 15.43" (392mm) H,<br>15.75" (400mm) W,<br>6.89" (175mm) D |
| Cabinet Dimensions: | 14.57" (370mm) H,<br>15.75" (400mm) W,<br>4.33" (110mm) D |

## SoundVision Technologies dba SUBWOOFER and ELECTRONIC PRODUCT WARRANTY

All subwoofers and amplifiers have a limited 5 year warranty. This warranty includes lifetime parts and repair labor on all components. The warranty extends only to the original purchaser of the product and not to any subsequent owner. TRUAUDIO's obligation under these warranties is limited to repairing or replacing any component found defective in material or workmanship under normal conditions of use with an equal and/or current product. These warranties shall not apply to products which have been abused, modified, or disassembled. Products to be repaired or returned under this warranty must be returned to the factory through an authorized TruAudio dealer with all transportation and insurance charges prepaid.

It is the policy of TRUAUDIO to continuously incorporate improvements into our products. All specifications are subject to change without notice. If you have any questions regarding this or any other TRUAUDIO products, please visit [www.TruAudio.com](http://www.TruAudio.com) or contact us:

Office: 1-888-858-1555, Monday-Friday 7 am - 6 pm MST.  
Fax: 435-251-9815  
Email: [CustomerService@truaudio.com](mailto:CustomerService@truaudio.com)

TruAudio  
198 N Old Highway 91  
Hurricane, UT 84737 USA